

Point	X	Y	Lat	Long
A	-3266927, 61114	-54339, 56748	-29, 51901	30, 43950
B	-3267002, 26282	-54325, 05187	-29, 51969	30, 43965
C	-3267072, 35217	-54311, 94230	-29, 52032	30, 43978
D	-3267265, 18494	-54325, 81474	-29, 52206	30, 43963
E	-3267309, 83112	-54354, 73120	-29, 52233	30, 43933
F	-3267309, 83112	-54382, 65833	-29, 52246	30, 43904
G	-3267315, 41655	-54441, 30532	-29, 52251	30, 43843
H	-3267289, 58395	-54465, 74156	-29, 52227	30, 43818
K	-3266984, 06917	-54418, 23150	-29, 51952	30, 43869
J	-3267055, 13419	-54416, 06053	-29, 52016	30, 43871
I	-3267265, 05723	-54473, 00036	-29, 52205	30, 43811
L	-3266949, 70719	-54484, 16749	-29, 51921	30, 43858

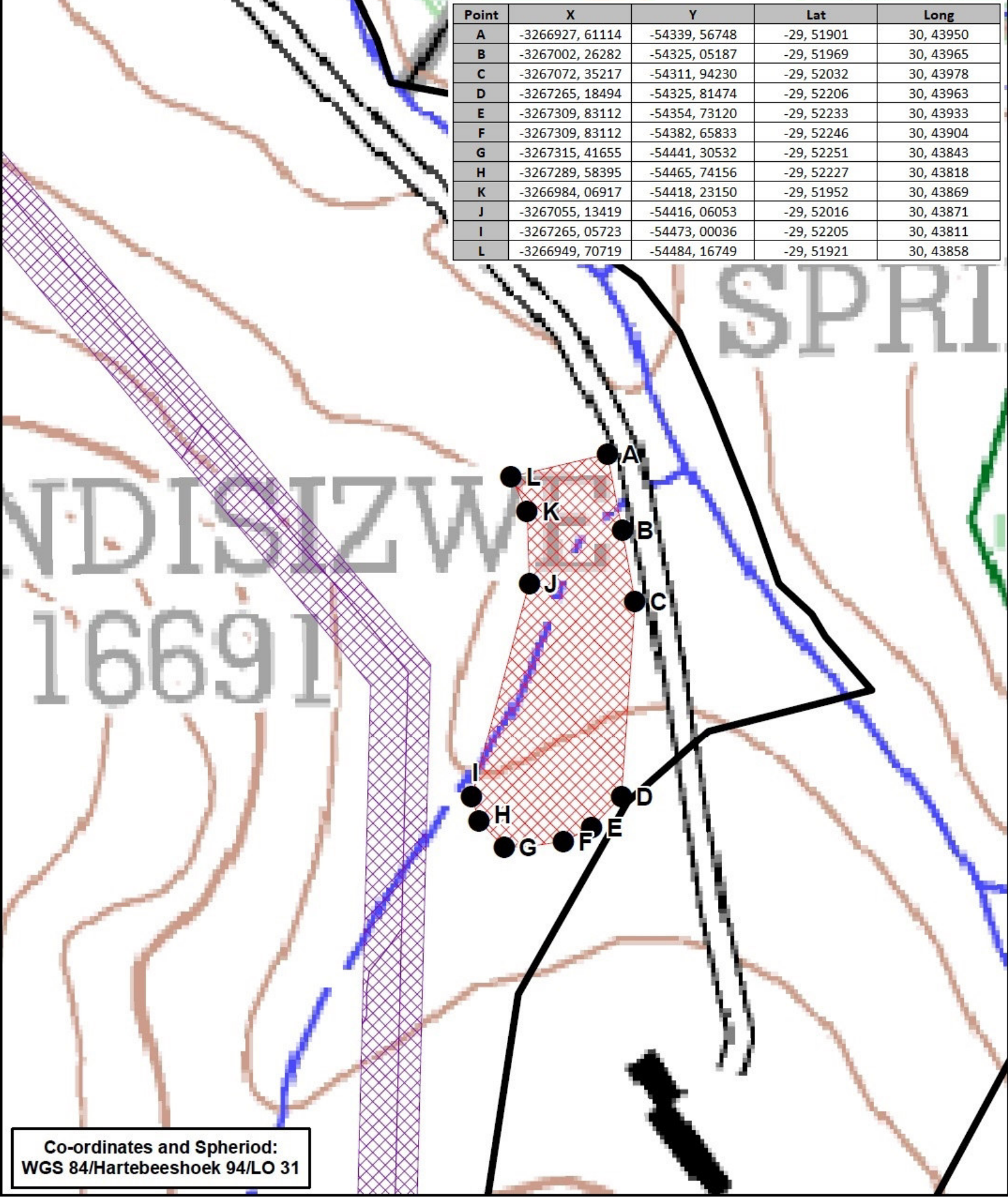

Co-ordinates and Spheriod:  
WGS 84/Hartebeeshoek 94/LO 31



**APPLICATION FOR MINING PERMIT  
ON REM OF THE FARM  
THANDISIZWE No. 16691**

**Proposed Mining  
Area (4.3ha)**

0 15 30 60 90 120  
Meters

1:5 000

**Legend**

- Farm Boundary
- Existing EPTL Servitude
- Points Mine
- Proposed Mining Area



**TrueNorth  
MAPPING PMB**

PO Box 100863, Scottsville,  
Pietermaritzburg 3209  
Tel: 033 346 0796 Fax: 033 346 0855

# Farm Thandisizwe

Disturbed areas



## LEGEND

- Site
- Disturbed area





Existing access road leading into quarry pit



Existing trench on western boundary



Existing access road on southern boundary leading to brick factory



Existing trench on western boundary overlooking quarry pit



Disturbed area above southern portion of quarry pit



Overlooking quarry pit from southern border