

INTERSECTION SETTING OUT CO-ORDINATES		
WGS84 Lo 29°		
Pt(c)	Y	X
01	-51 328.407	+3 379 208.605
02	-51 383.435	+3 379 109.662
03	-51 411.112	+3 379 056.323
04	-51 442.242	+3 379 004.421
05	-51 437.007	+3 378 983.790
06	-51 440.254	+3 378 978.740
07	-51 460.249	+3 378 974.315
08	-51 494.768	+3 378 924.036
09	-51 507.948	+3 378 902.062
10	-51 587.611	+3 378 776.437
11	-51 594.589	+3 378 780.741
12	-51 553.662	+3 378 848.996
13	-51 525.979	+3 378 902.350
14	-51 477.473	+3 378 983.199
15	-51 482.711	+3 379 003.826
16	-51 479.511	+3 379 008.905
17	-51 459.514	+3 379 013.333
18	-51 424.593	+3 379 064.175
19	-51 335.439	+3 379 212.822
20	-51 331.870	+3 379 210.802
21	-51 404.781	+3 379 082.057
22	-51 427.007	+3 379 052.180
23	-51 492.730	+3 378 935.404
24	-51 511.779	+3 378 903.684
25	-51 591.083	+3 378 776.631
26	-51 514.952	+3 378 905.559

HORIZONTAL ALIGNMENT - N2 WIDENING				
CURVE DETAILS				
CURVE No	RADIUS (m)	INT	LENGTH (m)	TANGENT (m)
-	-	-	-	-
CO-ORDINATES - WGS84 Lo 29°				
POINT	DISTANCE	DIRECTION	Y CO-ORDINATE	X CO-ORDINATE
START	0+000		-51 590.566	+3 378 779.494
	0+100		-51 539.129	+3 378 865.251
	0+200		-51 487.693	+3 378 951.008
	0+300		-51 436.256	+3 379 036.765
	0+400		-51 384.820	+3 379 122.522
	0+500		-51 333.383	+3 379 208.279
END	0+502.000		-51 332.355	+3 379 209.994

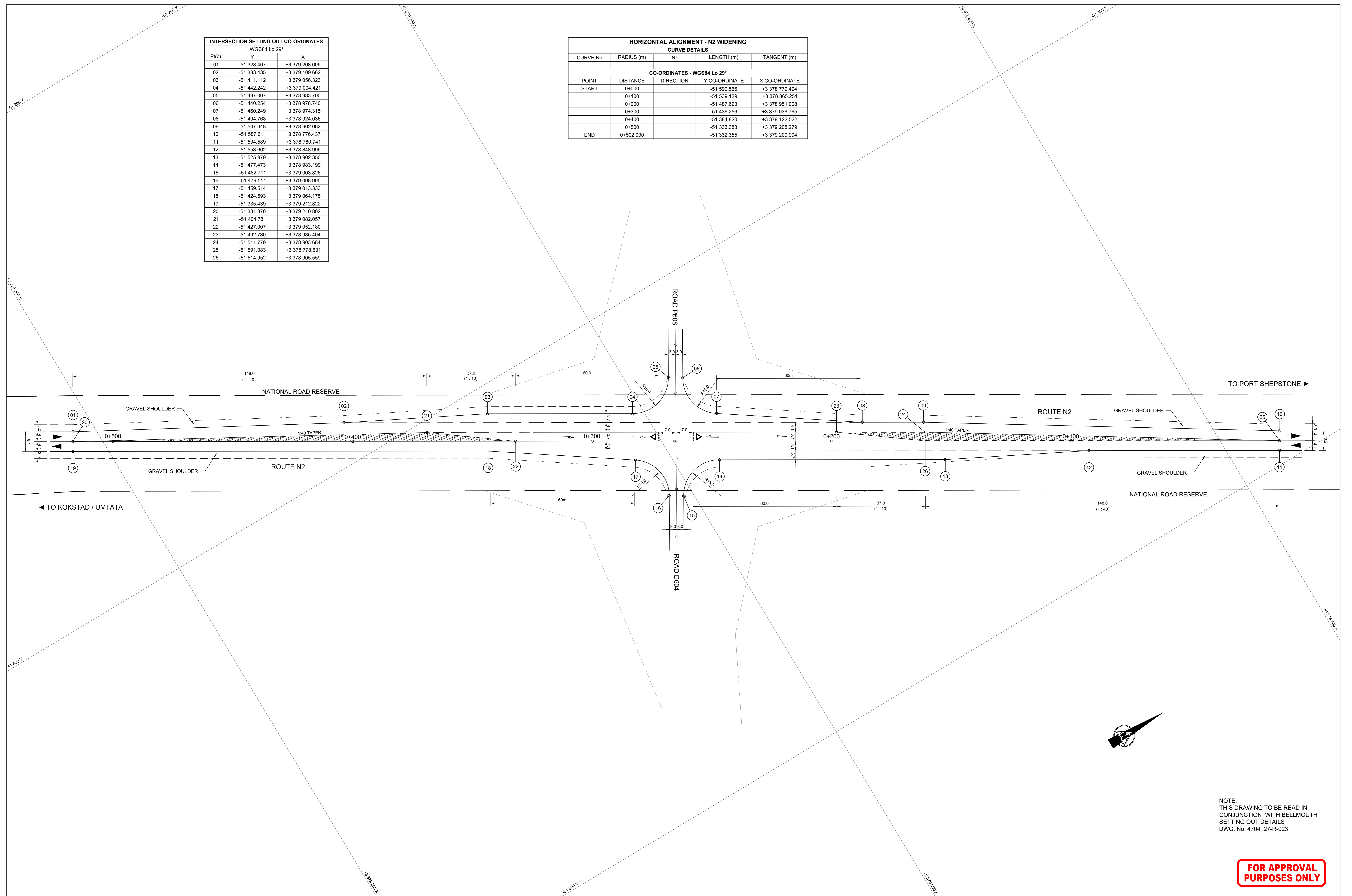

NOTE:
THIS DRAWING TO BE READ IN
CONJUNCTION WITH BELLMOUTH
SETTING OUT DETAILS
DWG. No. 4704_27-R-023

**FOR APPROVAL
PURPOSES ONLY**

Symbol	Date	Description	Checked	Signed
AMENDMENTS				

AS BUILT
Supervising Engineer: Date:
Supervising Authority:

Continued from:-
Continued on:-
Cross Section No:-
Longitudinal Section No:-
Survey Plan No:-

Designed by:- S. MOODLEY
Checked by:- S. MATENZHE
Drawn by:- B. NEWTON
Checked by:- S. MOODLEY
File Reference:-



Designed by:- **JG AFRIKA**
6 Pin Oak Ave. Hilton / P.O. Box 794 Hilton
TEL: (033) 343 6700
S.P. JANGALLI
for JG AFRIKA (Pty) Ltd
Date:
Dwg. No. 4704_27-R-022

TRANSPORTATION ENGINEERING:
CHIEF ENGINEER
HEAD: TRANSPORT

MAIN ROAD D604 / P608
PORTION
RE-ALIGNMENT OF D604 - P608
INTERSECTION SETTING OUT PLAN

Staked Km distance: -
Scale: 1 : 500
Sheet No: 1 of 1
Plan No: C.....

W:\Projects\4704 - Kokstad Consulting Services (S)A\4704_27 - Realignment of D604 - P608 - Chweng/Detailed Design\Working\030 - D604 INTERSECTION SETTING OUT PLAN 08-09-2021.dwg